

Profile View

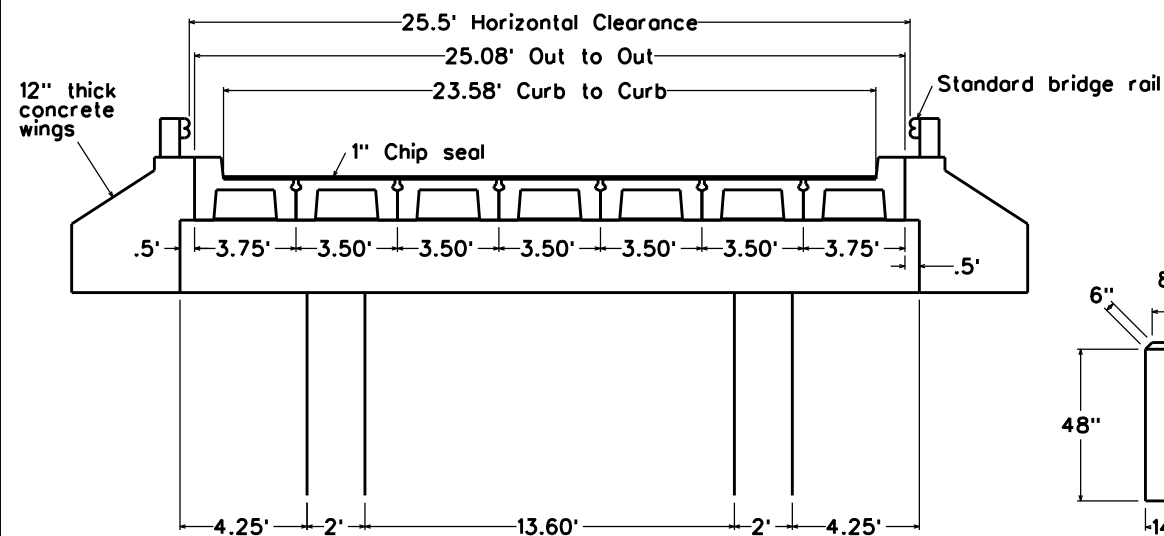

Cross Section View
Typical of Abutments and Interior Bents

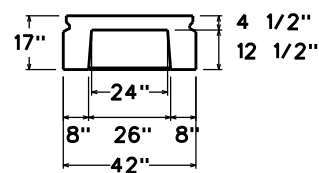

Interior Channel Beam Detail

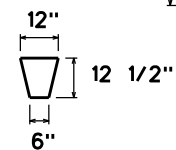

Diaphragm Detail

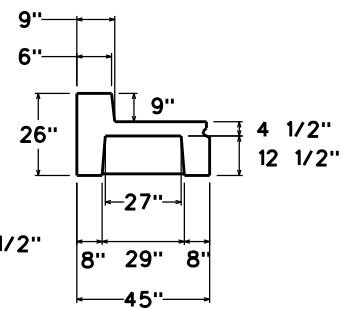

Exterior Channel Beam Detail

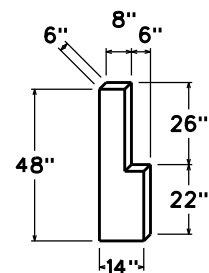

Bridge Rail Post

*Not to Scale

Bridge No. M1026	Dist. 5	Co. Izard - 33
Log 12.97	Rt. 56	Sect/Zone - 2
Date Drawn 12/13/04 Date Redrawn 11/23/10 By RRJ		

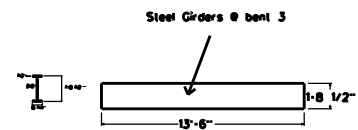
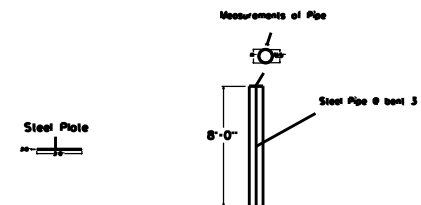
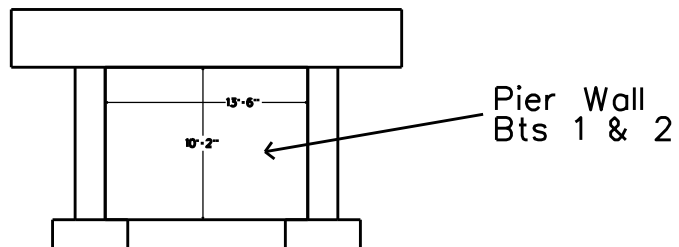
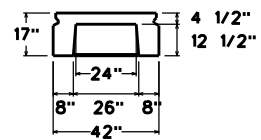
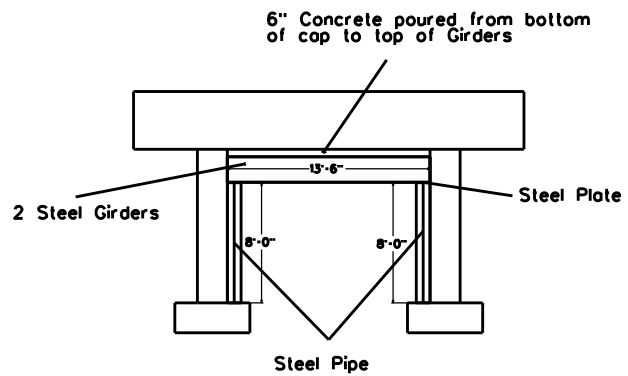

Bridge No. M1026	Dist. 5	Co. Icard - 33
Logmile 12.97	Rt. 00056	Sect/Zone - 2
Date Drawn 1/3/23		Drawn By JSF